

PAN ONLY FOR INWALL CISTERNS

RIMINI



FRONT VIEW



SIDE VIEW

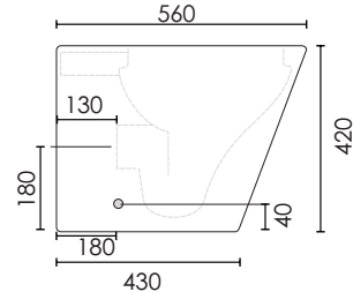

TOP VIEW

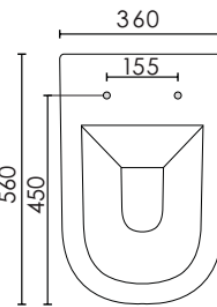

BACK VIEW

For inlet height, have actual pan onsite

370-380mm Approx

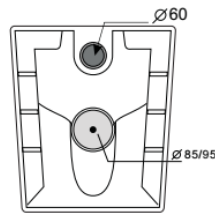

HOUSTON

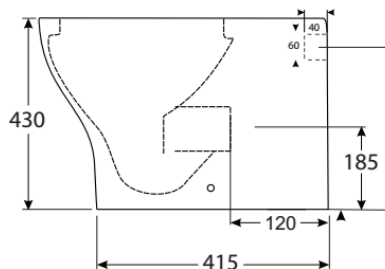
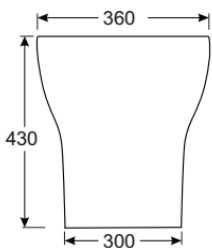
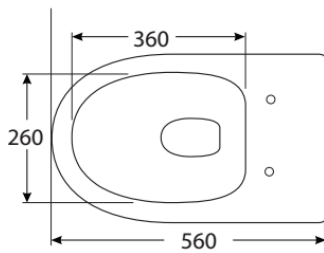

380-390mm Approx

For inlet height, have actual pan onsite



- RIMINI WALL FACED PAN 1630100
- SHORT PROJECTION 560MM
- RIMLESS FLUSH
- NANO COATED ANTI BACTERIAL
- ULTRA THIN SOFT CLOSE SEAT
- 4 STAR WELS 4.5/3L
- 60MM TO 80MM S TRAP SETOUT & P TRAP

- HOUSTON WALL FACED PAN 1630104
- RAISED HEIGHT 430MM TOP OF PAN
- TORNADO FLUSH
- NANO COATED ANTI BACTERIAL
- THIN SOFT CLOSE SEAT
- 4 STAR WELS 4.5/3L
- 60MM TO 80MM S TRAP SETOUT & P TRAP

• PLEASE ALLOW +/- 10MM VARIATIONS TO MEASUREMENTS

Cob and Pen