

# MANHATTAN CLASSIC

## Wall Hung

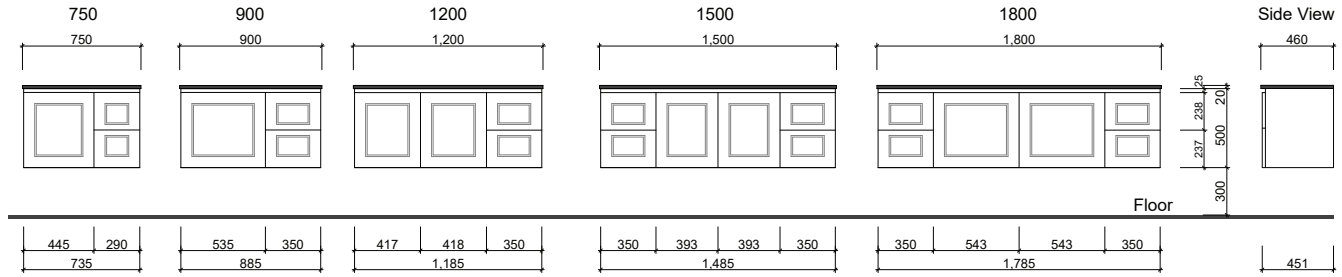

## Floor Standing

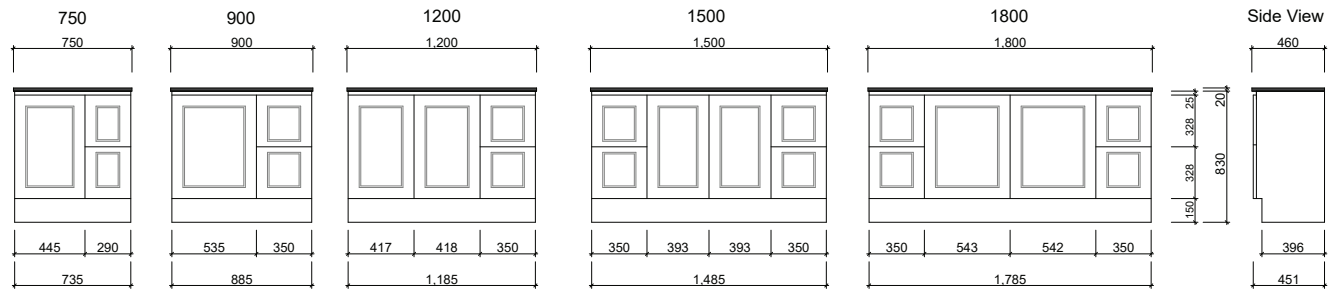

Waste size: Acrylic = 40mm, Ceramic = 32mm, Sculptured Marble = 32mm

Note: Where left or right hand options are available please specify or else cabinets will be supplied as per these drawings.

NOTE: All vanity top and basin sizes are nominal only. E&OE

# STANDARD CABINET COLOUR COLLECTION

Choose any of these colours on any of our Vanities, Tallboys, Shaving Cabinets or Mirrors - at no extra cost! White Gloss, White Satin & Black Satin are durable two pack polyurethane paint finish that are easy to clean. The Melamine woodgrain finishes are ultra durable and add warmth and colour to your bathroom. Some woodgrains have a matt finish while others have a realistic texture.

---



# SPECIAL PAINT COLOUR COLLECTION

Looking for an alternative to the old fashioned white and you're not keen on woodgrain? A special colour paint might be the option for you. For a one off cost of \$202, Timberline can colour match any paint of colour your choice. Taubmans, Dulux, Watty, you name it. The problem now is – what colour do you pick?!? We have picked six 'on trend' colours below. We've tested and tried them and they look fantastic. So if you're unsure, we've given you a helping hand.

As the table on the next page shows, we're keen to make sure your new bathroom includes the exact colour you're looking for. You're special, so you should be able to choose a special colour!

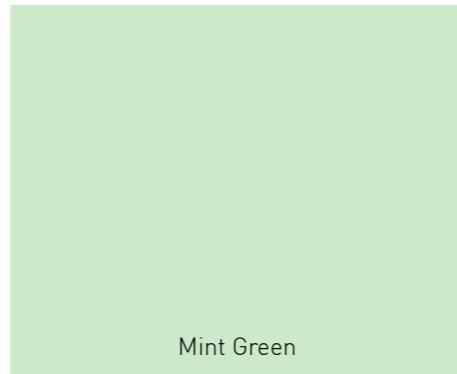
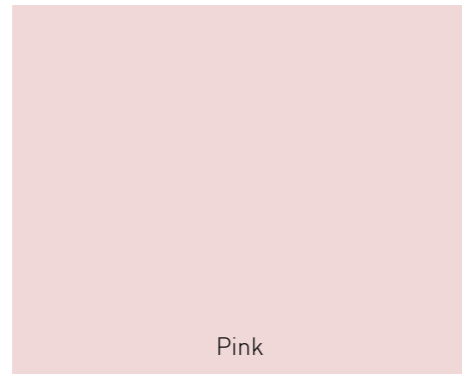
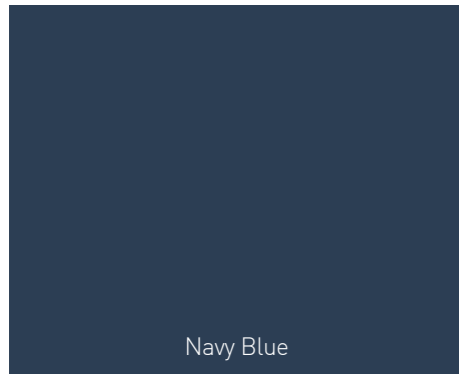
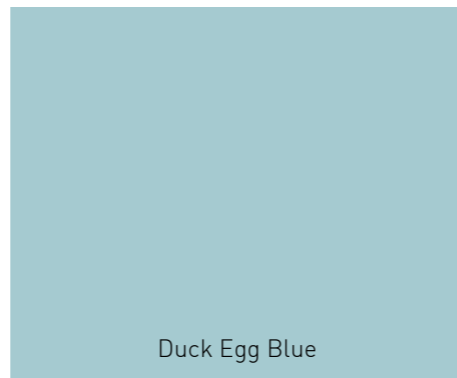
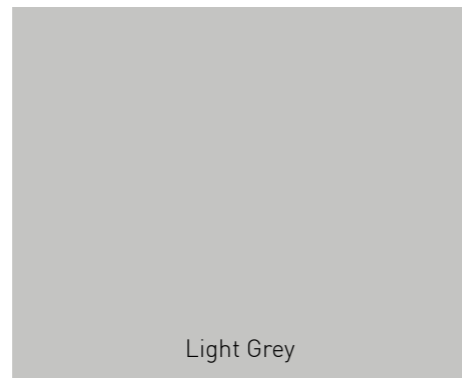
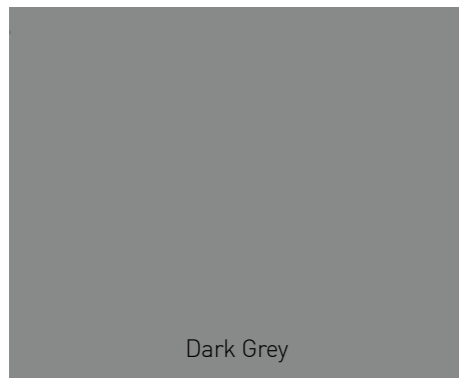

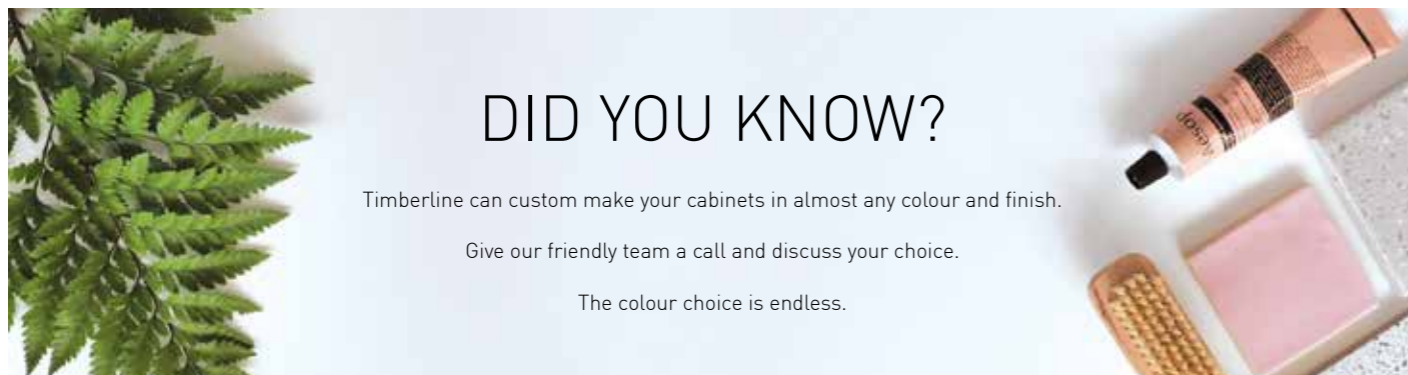

## DID YOU KNOW?

Timberline can custom make your cabinets in almost any colour and finish.

Give our friendly team a call and discuss your choice.

The colour choice is endless.

# SPECIAL CABINET COLOUR OPTIONS

COLOUR OPTIONS	PART NO.	\$ (per cabinet)
Laminex Melamine Special Colours	SPECCOLLAMIN	\$202
Formica Melamine Special Colours	SPECCOLFORMIC	\$202
Polytec Melamine Special Colours	SPECCOLPOLYT	\$202
Laminex Crystal Gloss Special Colours	SPECCOLLAMCGLOS	\$280
Polytec Ravine/Legato Special Colours	SPECCOLPOLYTTEX	\$280
All other Non Standard Melamine Colours		POA
<b>Special Paint Colour</b>	<b>SPECCOLPAINT</b>	<b>\$202</b>
<b>Ply Upgrade</b>	<b>SPECCOLPLY</b>	<b>\$252</b>



Images below are for illustration purposes. Please refer to the colour swatch for colour.



## ACRYLIC VANITY TOPS

Acrylic vanity tops are formed from a durable acrylic sheet. This is heat formed to an exact mould and then back filled with a heavy compound.

- ✓ Massive range of sizes
- ✓ Very straight and flat
- ✓ Durable & Strong
- ✓ Easy to repair if scratched
- ✓ Not susceptible to chipping
- ✓ 10 Year warranty
- ✓ Australian Made
- ✓ Available in 0,1 or 3TH options\*
- ✗ No Overflow
- ✗ Susceptible to heat damage (e.g. hair straightener)



REGAL ACRYLIC

# CABINET HANDLE COLLECTION

What a selection! Choose from chrome, brushed, black or white - long or short - square or curved. We've got them all! Customise your cabinet with any of these stunning handle options at no extra cost!

**ARCH HANDLE** AVAILABLE IN 244mm & 340mm

CHROME | BRUSHED NICKEL | BLACK | WHITE

**CURVE HANDLE** AVAILABLE IN 198mm & 359mm

CHROME | BRUSHED NICKEL | BLACK | WHITE

**SQUARE HANDLE** AVAILABLE IN 224mm & 352mm

CHROME | BRUSHED NICKEL | BLACK | WHITE

**ROUND KNOB\***

CHROME | BRUSHED NICKEL | BLACK | WHITE

**RETRO HANDLE\***

CHROME | BRUSHED NICKEL | BLACK | WHITE | PEWTER

**D HANDLE** AVAILABLE IN 138mm\*, 230mm, 361mm & 457mm

CHROME | BRUSHED NICKEL | BLACK | WHITE

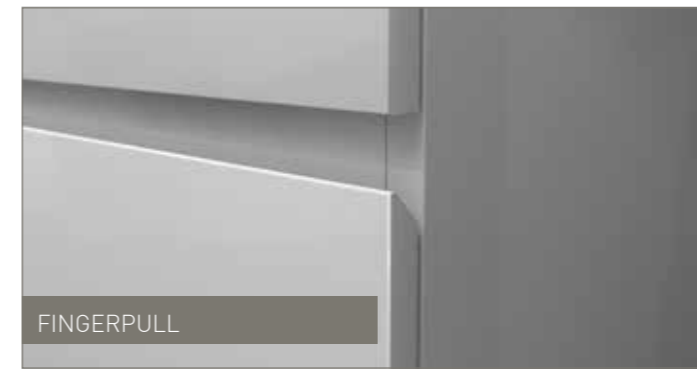
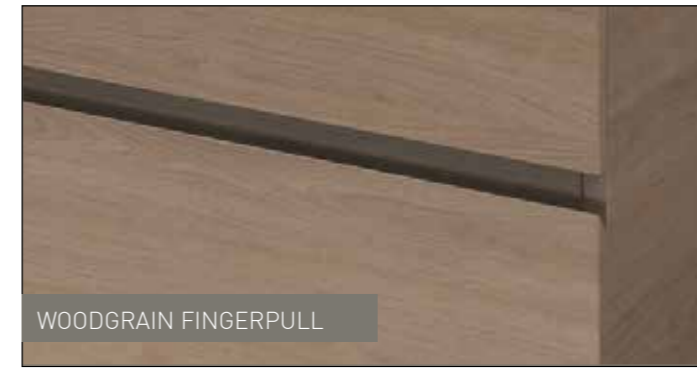

**MOUNTING HOLE CENTRES**

Handle Type	244mm	340mm		
ARCH	224mm Holes	320mm Holes		
CURVE	198mm	359mm		
Mounting Hole Centres	160mm Holes	320mm Holes		
SQUARE	224mm	352mm		
Mounting Hole Centres	192mm Holes	320mm Holes		
D HANDLE	138mm	230mm	361mm	457mm
Mounting Hole Centres	128mm Holes	224mm Holes	352mm Holes	448mm Holes
RETRO				
Mounting Hole Centres	64mm			

\*Denotes handles suitable size for the Classic Fronts on Nevada Classic

**Notes for Finger Pull Option:**

Usable drawer height is reduced with finger pulls. Drawer and door widths might vary depending on cabinet layout.  
**Available in all colours. Not recommended on Classic shaker panels.**